

**USE IN CONJUNCTION WITH YOUR MAIN THERMASKIRT® INSTALLATION INSTRUCTIONS**

**IMPORTANT:** Unless the ThermaSkirt® has been supplied factory cut, it is **ESSENTIAL** that the skirting is deburred. 10 revolutions of the ThermaSkirt® de-burrer or similar de-burring tool is recommended. A 'Bell Mouth' chamfer of (approx.) 2mm x 2mm is best to enable ease of installation of connectors. Any swarf or chippings **MUST** be removed before inserting any fittings into the skirting's feed and return channels. Otherwise your **WARRANTY MAY BE INVALID!** (See main installation instructions for full details. To download, go to [www.discreteheat.co.uk/technical.htm](http://www.discreteheat.co.uk/technical.htm)).

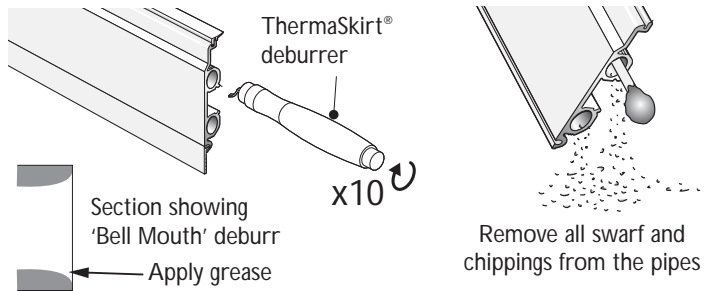

**135° FLEXIBLE CORNER KIT**

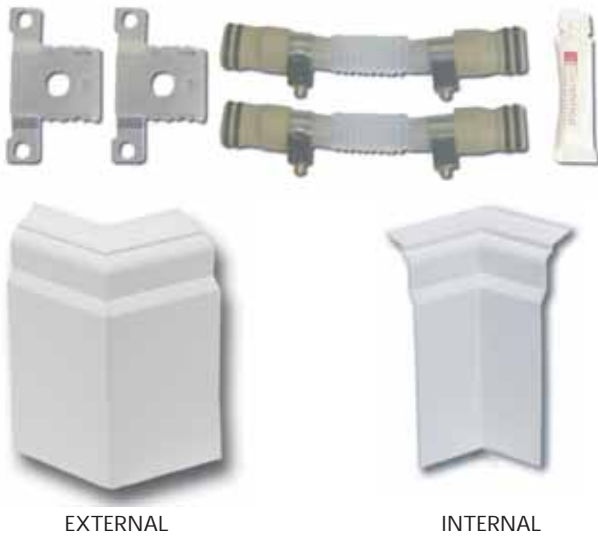

135° external and internal sections of skirting are cut to within 50mm of the length of wall that it is fitting to (A).

It is essential that all external corner connectors are held in place with a connector clip (B). Push the connector clips into the skirting before fitting the connectors. Fitting is by pushing the skirting onto the mounting brackets (first click) (C) and sliding onto the connectors.

**USE THE SILICON GREASE PROVIDED!**

When the connection is made, push the skirting fully onto the mounting channel until it clicks in position. Ensure that the tabs of the connector clips are properly in place over the bumps on the corner connectors.

When the skirting on both sides of the corner is in place, fit the corner cover in position by hooking over the top of each side of skirting, then pushing the bottom inwards until it clicks. Trim the cable cover and caulking gasket 5mm longer than required. These may then be tucked behind the corner covers and end covers to achieve a neat finish (D).

Special external corner covers may be required in some installations. Download a template from: [www.discreteheat.co.uk/technical.html](http://www.discreteheat.co.uk/technical.html)

